

## NIPPON THOMPSON CO., LTD. (JAPAN)

Head Office : 19-19, Takanawa 2-chome, Minato-ku,  
Tokyo, 108-8586, Japan  
Phone : +81 (0)3-3448-5850  
Fax : +81 (0)3-3447-7637  
E-mail : ntt@ikonet.co.jp  
URL : <https://www.ikont.co.jp/eg/>  
Plant : Gifu, Kamakura



## IKO INTERNATIONAL, INC. (U.S.A.)

### East Coast Operations (Sales Head Office)

91 Walsh Drive,  
Parsippany, NJ, 07054,  
U.S.A.  
Phone : +1-973-402-0254  
Toll Free : +1-800-922-0337  
Fax : +1-973-402-0441  
E-mail : eco@ikonet.co.jp



### Midwest Operations

101 Mark Street, Unit-G,  
Wood Dale, IL, 60191,  
U.S.A.  
Phone : +1-630-766-6464  
Toll Free : +1-800-323-6694  
Fax : +1-630-766-6869  
E-mail : mwo@ikonet.co.jp

### Minnesota Sales Office

1500 McAndrews Road West, Suite 210,  
Burnsville, MN, 55337,  
U.S.A.  
Phone : +1-952-892-8415  
Toll Free : +1-800-323-6694  
Fax : +1-952-892-1722  
E-mail : mwo@ikonet.co.jp

### West Coast Operations

9830 Norwalk Boulevard, Suite 198,  
Santa Fe Springs, CA, 90670,  
U.S.A.  
Phone : +1-562-941-1019  
Toll Free : +1-800-252-3665  
Fax : +1-562-941-4027  
E-mail : wco@ikonet.co.jp

### Silicon Valley Sales Office

1500 Wyatt Drive, Suite 10,  
Santa Clara, CA, 95054,  
U.S.A.  
Phone : +1-408-492-0240  
Toll Free : +1-800-252-3665  
Fax : +1-408-492-0245  
E-mail : wco@ikonet.co.jp

### Southeast Operations

3235 Satellite Boulevard Building 400, Suite 230,  
Duluth, GA, 30096,  
U.S.A.  
Phone : +1-770-418-1904  
Toll Free : +1-800-874-6445  
Fax : +1-770-418-9403  
E-mail : seo@ikonet.co.jp

### Southwest Operations

8105 N. Beltline Road, Suite 130,  
Irving, TX, 75063,  
U.S.A.  
Phone : +1-972-929-1515  
Toll Free : +1-800-295-7886  
Fax : +1-972-915-0060  
E-mail : swo@ikonet.co.jp

## IKO THOMPSON BEARINGS CANADA, INC.(CANADA)

731-2425, Matheson Boulevard East, 7th floor,  
Mississauga, Ontario, L4W 5K4, Canada  
Phone : +1-905-361-2872  
Fax : +1-905-361-6401  
E-mail : itc@ikonet.co.jp

## IKO BRASIL SERVIÇOS EMPRESARIAIS EIRELI (BRAZIL)

Rua Frei Caneca 1407,  
Condominio Edifício Barão de Monte Cedro,  
Cjs. 801/802, Consolação, São Paulo- SP  
Cep: 01307-909  
Phone : +55 (0)11-2366-3033  
E-mail : itb@ikonet.co.jp

## NIPPON THOMPSON EUROPE B.V. (EUROPE)

### The Netherlands (Sales Head Office)

Keersopstraat 35,  
3044 EX, Rotterdam,  
The Netherlands  
Phone : +31 (0)10-462 68 68  
E-mail : nte@ikonet.co.jp



### Germany Branch

Mündelheimer Weg 54,  
40472 Düsseldorf,  
Germany  
Phone : +49 (0)211-41 40 61  
Fax : +49 (0)211-42 76 93  
E-mail : ntd@ikonet.co.jp

### Regensburg Sales Office

Im Gewerbepark D 30,  
93059 Regensburg,  
Germany  
Phone : +49 (0)941-20 60 70  
Fax : +49 (0)941-20 60 719  
E-mail : ntdr@iko-nt.de

### Neunkirchen Sales Office

Gruben Str. 95c,  
66540 Neunkirchen,  
Germany  
Phone : +49 (0)6821-99 98 60  
Fax : +49 (0)6821-99 98 626  
E-mail : ntdn@iko-nt.de

### U.K. Branch

2 Vincent Avenue, Crownhill,  
Milton Keynes, Bucks, MK8 0AB,  
United Kingdom  
Phone : +44 (0)1908-566144  
E-mail : sales@iko.co.uk

### Spain Branch

Autovia Madrid-Barcelona, Km. 43,700  
Polig. Ind. AIDA - Nove A-8, Ofic. 2-1<sup>a</sup>  
19200-Azuqueca de Henares,  
(Guadalajara) Spain  
Phone : +34 949-26 33 90  
Fax : +34 949-26 31 13  
E-mail : nts@ikonet.co.jp

### France Branch

Bâtiment le Raphaël-Paris, Nord 2,  
22 avenue des Nations  
BP54394 Villepinte  
95943 ROISSY C.D.G Cedex  
France  
Phone : +33 (0)1-48 16 57 39  
Fax : +33 (0)1-48 16 57 46  
E-mail : ntf@ikont.eu

## IKO THOMPSON ASIA CO., LTD. (THAILAND)

1-7 Zuellig House, 3rd Floor,  
Silom Road, Silom, Bangrak,  
Bangkok 10500, Thailand  
Phone : +66 (0)2-637-5115  
Fax : +66 (0)2-637-5116  
E-mail : ita@ikonet.co.jp

## IKO THOMPSON KOREA CO.,LTD. (KOREA)

201, Worldvision Bldg., 77-1, Yeouinaru-ro,  
Yeongdeungpo-gu, Seoul, Korea  
Phone : +82 (0)2-6337-5851  
Fax : +82 (0)2-6337-5852  
E-mail : itk@ikonet.co.jp

## IKO-THOMPSON (SHANGHAI) LTD. (CHINA)

### Shanghai (Sales Head Office)

1608-10, MetroPlaza No.555, LouShanGuan  
Road, ChangNing District, Shanghai,  
People's Republic of China, 200051  
Phone : +86 (0)21-3250-5525  
Fax : +86 (0)21-3250-5526  
E-mail : ntc@ikonet.co.jp

### Beijing Branch

Room 1909, Tower C Oriental Media Center,  
Guanghua Road No. 4 Chaoyang District, Beijing,  
People's Republic of China, 100026  
Phone : +86 (0)10-6515-7681  
Fax : +86 (0)10-6515-7689  
E-mail : ntc@ikonet.co.jp

### Guangzhou Branch

Room 834, Garden Tower, Garden Hotel  
368 Huanshi East Road, Yuexiu District, Guangzhou,  
Guangdong  
People's Republic of China, 510064  
Phone : +86 (0)20-8384-0797  
Fax : +86 (0)20-8381-2863  
E-mail : ntc@ikonet.co.jp

### Wuhan Branch

Room 2300, Truroll Plaza No.72, Wusheng Road,  
Qiao kou District, Wuhan, Hubei,  
People's Republic of China, 430033  
Phone : +86 (0)27-8556-1610  
Fax : +86 (0)27-8556-1630  
E-mail : ntc@ikonet.co.jp

### Shenzhen Branch

Room1808, KEENSTAR Building 18,  
Chuangye 2nd Rd 248, Bao'an, Shenzhen, Guangdong,  
People's Republic of China, 518081  
Phone : +86 (0)755-2265-0553  
Fax : +86 (0)755-2298-0665  
E-mail : ntc@ikonet.co.jp

### Xian Branch

Room 2010, Block B, Chaoyang International Plaza,  
No. 166,  
Changle West Road, Xincheng District Xi'an, Shanxi,  
People's Republic of China, 710032  
Phone : +86 (0)29-8323-5915  
E-mail : ntc@ikonet.co.jp

### Ningbo Office

Room 3406, Zhongnongxin Building, No.181,  
Zhongshan East Road, Haishu Ward, Ningbo,  
Zhejiang  
People's Republic of China, 315000  
Phone : +86 (0)574-8718-9535  
Fax : +86 (0)574-8718-9533  
E-mail : ntc@ikonet.co.jp

### Qingdao Office

Room 1111, Building 9, Qingdao Science and  
Technology City, No. 7 Wuyang Road,  
North District, Qingdao City, Shandong,  
People's Republic of China, 266045  
Phone : +86 (0)532-8670-2246  
Fax : +86 (0)532-8670-2242  
E-mail : ntc@ikonet.co.jp

### Shenyang Office

2-1203 Tower I, City Plaza Shenyang NO.206,  
Nanjing North Street, Heping District, Shenyang,  
People's Republic of China, 110001  
Phone : +86 (0)24-2334-2662  
Fax : +86 (0)24-2334-2442  
E-mail : ntc@ikonet.co.jp

# IKO

New

Micro Linear Way L

# LWLF2

The smallest size available in the  
Linear Way L Series (wide rail type)

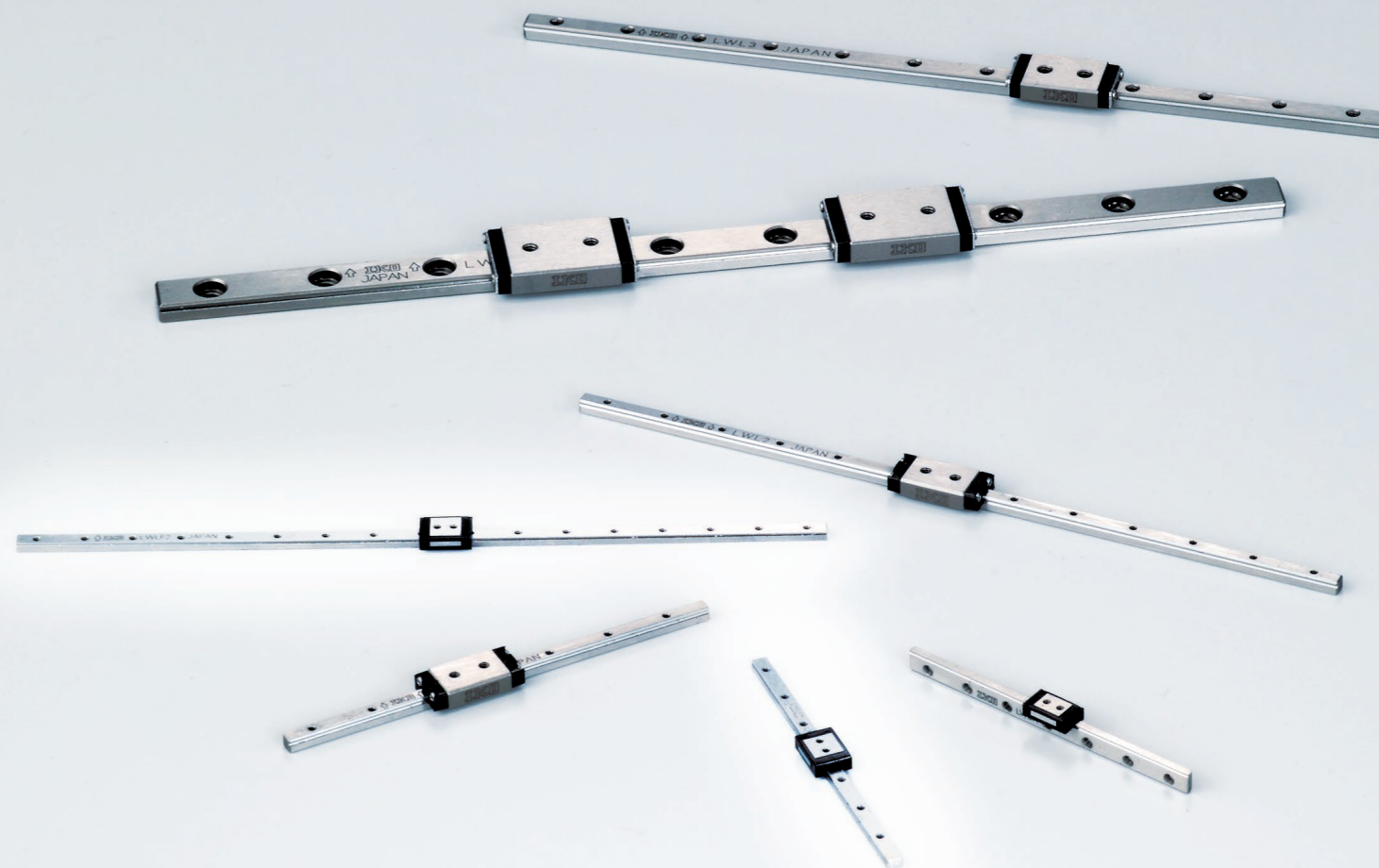

• The specifications and dimensions of products in this catalog are subject to change without prior notice. • When these products are exported, the exporter should confirm a forwarding country and a use, and, in case of falling under the customer's requirements, take necessary procedures such as export permission application. • Although all data in this catalog has been carefully compiled to make the information as complete as possible, NIPPON THOMPSON CO., LTD. shall not be liable for any damages whatsoever, direct or indirect, based upon any information in this catalog. NIPPON THOMPSON CO., LTD. makes no warranty, either express or implied, including the implied warranty of merchantability or fitness for a particular purpose. • Reproduction and conversion without permission are prohibited.



ISO 9001 & 14001 Quality system registration certificate

# HIGH PRECISION AND ULTRA SMALL SIZE

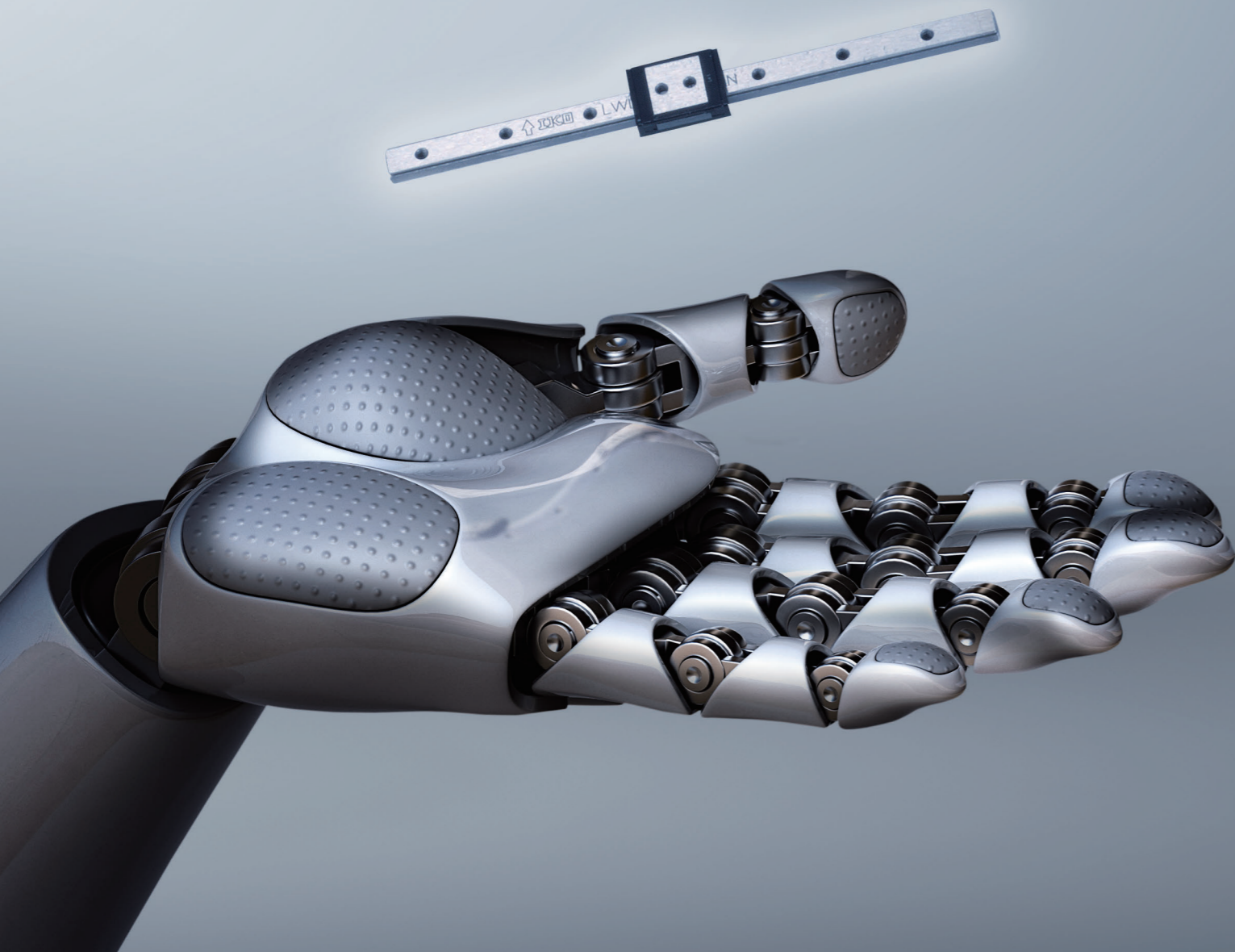

## Structure

Ultra-small linear motion rolling guide produced by original miniature technology. Despite its very small body, and thanks to the structure with two rows of balls that contact with the raceway at four points, stable accuracy and rigidity can be achieved even in applications where load has variable direction and size or complex load is applied.

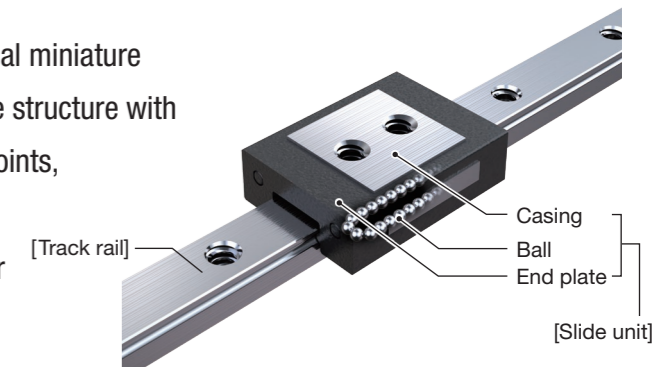

## Features

1

### Simple assembly

A tapped rail (mounted from the bottom) is used as the track rail for stability.



2

### Ultra-small size

Original miniature technology provides the lowest sectional height in the industry.

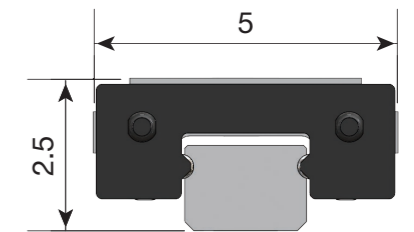

3

### Stainless steel for excellent corrosion resistance

Stainless steel, which is highly resistant to corrosion, is used as the basic specification, making these products suitable for applications where rust prevention oil is not preferred, such as in a cleanroom environment.





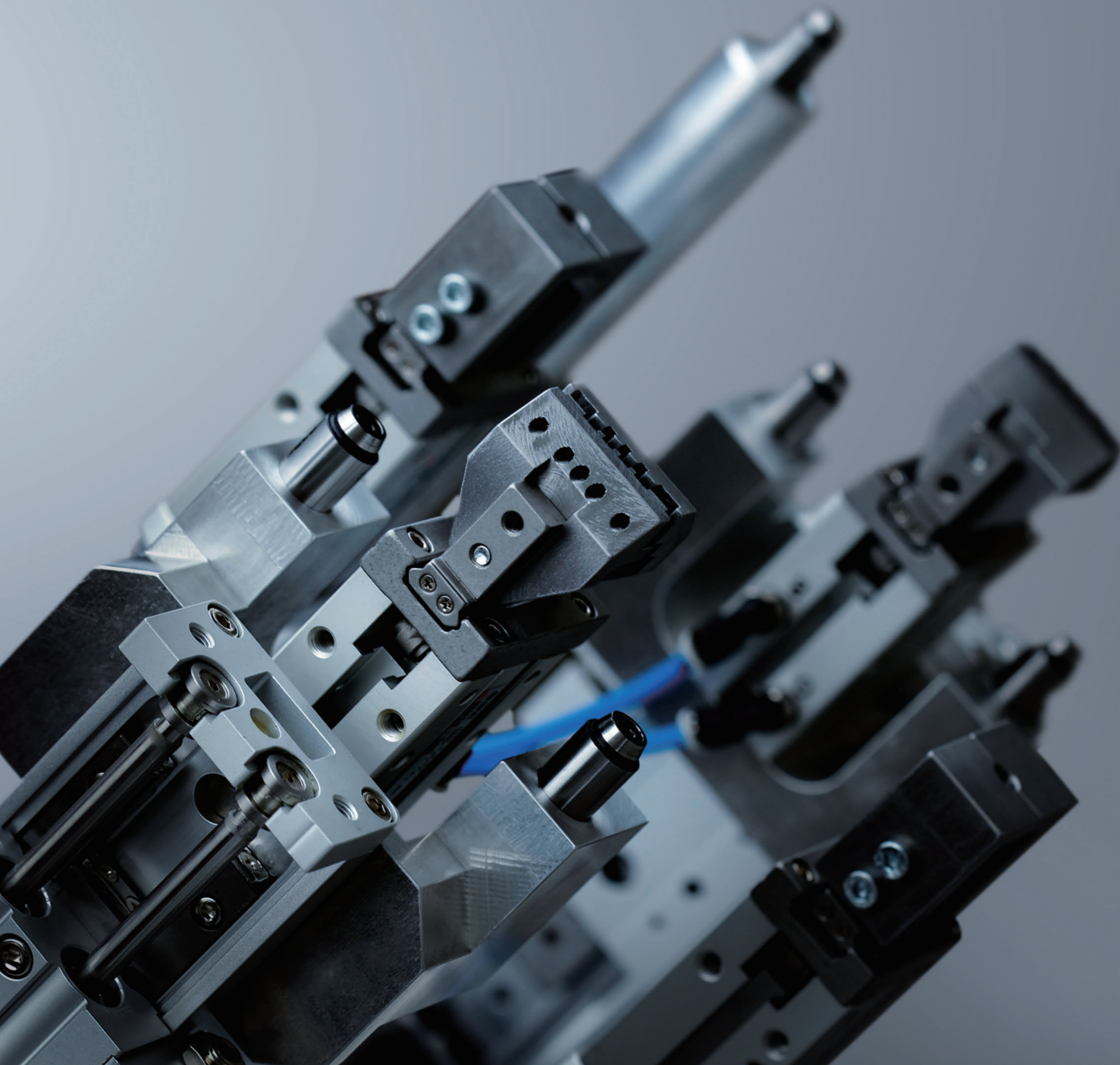

# FOR VARIOUS USES INCLUDING A GRIPPER



## Models and Sizes

Shape	Length of slide unit	Model	Size									
			1 <sup>(1)(2)</sup>	2 <sup>(1)(3)</sup>	3 <sup>(1)(3)</sup>	5	7	9	12	15	20	25
 Standard type	Short 	LWLC	—	—	☆	☆	☆	☆	☆	☆	☆	☆
	Standard 	LWL	☆	☆	☆	☆	☆	☆	☆	☆	☆	☆
	Long 	LWLG	—	—	—	—	☆	☆	☆	☆	☆	☆

Shape	Length of slide unit	Model	Size								
			2 <sup>(1)(3)</sup>	4 <sup>(1)</sup>	6 <sup>(1)</sup>	10	14	18	24	30	42
 Wide rail type	Short 	LWLFC	—	—	☆	☆	☆	☆	☆	☆	☆
	Standard 	LWLF <span style="color: red; font-weight: bold;">New</span>	☆	☆	☆	☆	☆	☆	☆	☆	
	Long 	LWLFG	—	—	—	—	☆	☆	☆	☆	

Notes (1) Balls are not retained. No end seal is attached.





(2) Either tapped rail specification (mounted from lateral) or solid rail specification is used for the track rail.

(3) Tapped rail specification (mounted from bottom) is used for the track rail.

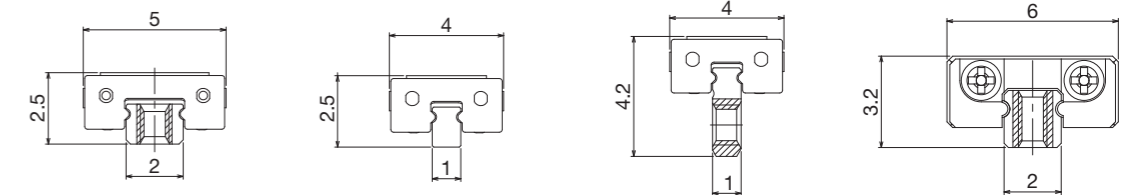
Remark:  shows that there is interchangeable specification that allows free combination between slide units and track rails.

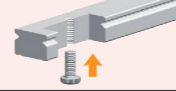
## Micro Linear Way Specification Comparison



Identification number	<span style="color: red; font-weight: bold;">New</span> LWLF2	LWL1	LWL1...Y	LWL2	
Total height	2.5	2.5	4.2	3.2	
Width	Slide unit [mm]	5	4	6	
	Track rail [mm]	2	1	1	2
Mass	Slide unit [g]	0.21	0.16	0.16	0.9
	Track rail (per 100mm) [g]	2.0	1.0	2.1	2.8
Track rail model	Tapped rail specification mounted from bottom 	Solid rail specification (no mounting hole) 	Tapped rail specification mounted from lateral 	Tapped rail specification mounted from bottom 	
Basic dynamic load rating $C$ [N]	66.8	66.8	66.8	221	
Basic static load rating $C_0$ [N]	113	113	113	381	
Static moment rating	$T_0$ [N·m]	0.12	0.06	0.06	0.42
	$T_x$ [N·m]	0.07	0.07	0.07	0.54
	$T_y$ [N·m]	0.09	0.09	0.09	0.64
Features	Compact at the same sectional height as LWL1, with excellent track rail mounting	The smallest Linear Way with a track rail width of only 1mm	Simple track rail mounting with the same width as LWL1	Minimal size with excellent load capacity	

## Identification number

Example	LWLF	2	C1	R18	T <sub>0</sub>	H	/I
	1	2	3	4	5	6	7

**1 Model**

Model	
LWLF	Wide rail type

**2 Size**

Size	
2	

**3 Number of slide units**

Number of slide units (CO)	
Specifies the number of slide units assembled on one track rail.	

**4 Length of track rail**

Length of track rail (RO)	
Indicates the length of track rail in mm. For standard and maximum lengths, see Table 1.	

**5 Preload amount**

Preload amount	
T <sub>0</sub> : Clearance	For details of the preload amount, see Table 2.

**6 Accuracy class**

Accuracy class	
H: High	For details of accuracy class, see Table 3.
P: Precision	

**7 Special Specification**

Special Specification	
/E	Specified rail mounting hole positions
/I	Inspection sheet
/W	A group of multiple assembled sets

## Details of specifications

Table 1 Standard and maximum lengths of track rail  
unit: mm

Item	Identification number	LWLF2
Standard length L <sup>(1)</sup>		18 (3)
		30 (5)
		42 (7)
		54 (9)
Pitch of mounting holes F		6
E		3
Standard E dimensions	or higher	2.5
	below	5.5
Maximum length		102

Note (1) The value in ( ) indicates the number of mounting holes.

Remark: If not directed, E dimensions for both ends will be the same within the range of standard E dimensions. To change the dimensions, indicate the specified rail mounting hole positions /E of special specification.

Table 2 Preload amount  
unit: mm

Preload type (preload symbol)	Clearance (T <sub>0</sub> )
Preload amount [N]	0 <sup>(1)</sup>
Operating conditions	Very light motion

Note (1) Zero or minimal clearance.

Table 3 Tolerance and allowance

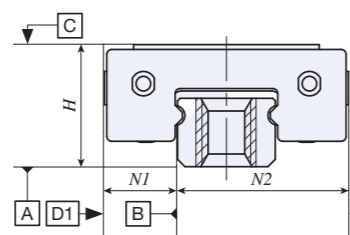
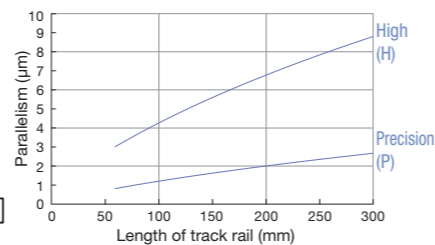

Fig. 1 Parallelism in operation



Item	High (H)	Precision (P)
H deviation	±0.020	±0.010
NI and N2 deviation	±0.025	±0.015
H deviation variation <sup>(1)</sup>	0.015	0.007
N deviation variation <sup>(1)</sup>	0.020	0.010
Parallelism in operation of the slide unit C surface to A surface	See Fig. 1. (If the track rail length is less than 60mm, the value will be the same as 60mm)	
Parallelism in operation of the slide unit D1 (D2) surface to B surface	See Fig. 1. (If the track rail length is less than 60mm, the value will be the same as 60mm)	

Note (1) The value shows variation of slide units incorporated in the same track rail.

## Mounting methods

Properly align the reference mounting surface B and D1 or D2 of the track rail and slide unit with the reference mounting surface of the table and bed, and fix them in place.

The reference mounting surfaces B and D1, and D2 and mounting surfaces A and C are precisely ground. Machining the mating mounting surface (of the machine, device, etc.) to a high degree of accuracy and mounting them properly will ensure stable linear motion with high accuracy.

The track rail reference mounting surface B is identified by the mark on the top surface of the track rail. It is the side surface above the mark (in the direction of the arrow).

The reference mounting surface of the slide unit is located at both right and left sides (D1 and D2).

It is recommended to add a shoulder to the mating reference mounting surface as shown in the figure to the right. The shoulder height of the track rail should be set to a position (height) where it does not interfere with the slide unit.

The recommended screw tightening torque when mounting the product to a steel mating member material is shown in the table below.

It is recommended to use a tightening torque of 70 to 80% of the value in the table for slide unit mounting holes.

Bolt size	Tightening torque N·m
	Stainless steel-made screw
M1 × 0.25	0.04

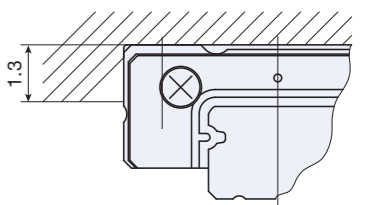
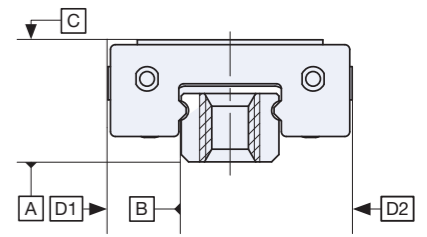

Mounting part of slide unit

## Product dimensions

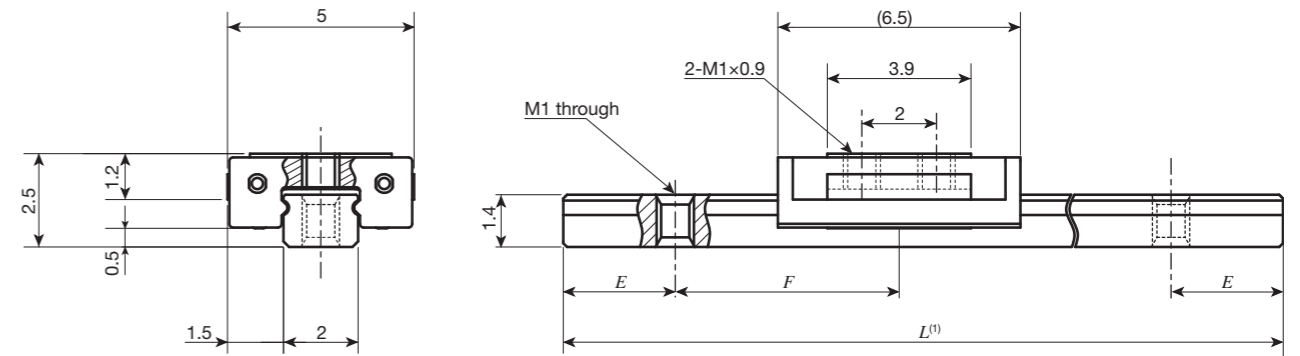

Identification number	Mass (Ref.)		Mounting bolt for track rail mm <sup>(2)</sup>	Basic dynamic load rating <sup>(3)</sup> C N	Basic static load rating <sup>(3)</sup> C <sub>0</sub> N	Static moment rating <sup>(3)</sup>		
	Slide unit g	Track rail (per 100mm) g				T <sub>0</sub> N·m	T <sub>x</sub> N·m	T <sub>y</sub> N·m
LWLF2	0.21	2.0	M1 × □ <sup>(4)</sup>	66.8	113	0.12	0.07 0.47	0.09 0.56

Note (1) The dimensions of track rail are described in Table 1.

(2) Track rail mounting bolts are not appended.

(3) The directional values for basic dynamic load rating (C), basic static load rating (C<sub>0</sub>), and static moment rating (T<sub>0</sub>, T<sub>x</sub>, T<sub>y</sub>) are shown in the figures below.

The upper values of T<sub>x</sub> and T<sub>y</sub> are for one slide unit, and the lower values are for two slide units in close contact.

(4) Concerning screw length □, prepare the screws whose fixing thread depth is less than the track rail height dimension.

Remarks (1) Balls are not retained. No end seal is attached.

(2) No oil hole is prepared. For re-greasing, apply the grease directly to the raceway of the track rail.

